

## Tipner Lane, Portsmouth, PO2 8AN



## Park & Ride waiting room facility

- Gateway to the M275.
- GIA 1,400 sq ft.
- Rare opportunity.
- Offers invited for new commercial lease.

**023 9284 1546 / 023 9283 4349**  
CommercialPropertyToLet@portsmouthcc.gov.uk

**TO LET**

# Park & Ride waiting room facility Tipner Lane, Portsmouth, PO2 8AN

## LOCATION

Previous building located in popular park and ride facility – large prominent gateway site at entrance of Portsmouth, straddling M275 motorway with water frontage onto both Portsmouth Harbour and Tipner Lake.

## ACCOMMODATION

Currently divided into: waiting room facility, two storage rooms, female toilet and male toilet. The toilet facilities are to be shared with the Park and Ride facility.

## SERVICES

Electricity and water

## TERM

Term, rent and principle lease terms on application

## REPAIRS AND MAINTENANCE

Tenant will be responsible for keeping interior in good repair and condition throughout term. Tenant responsible for maintaining internal glass and plate glass frames and doors.

## VIEWING

Strictly by appointment only.

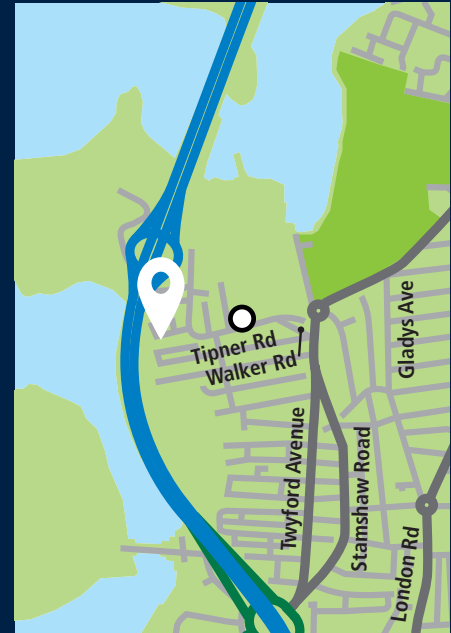

© Crown Copyright and database right 2016. Ordnance Survey licence number 100019671.

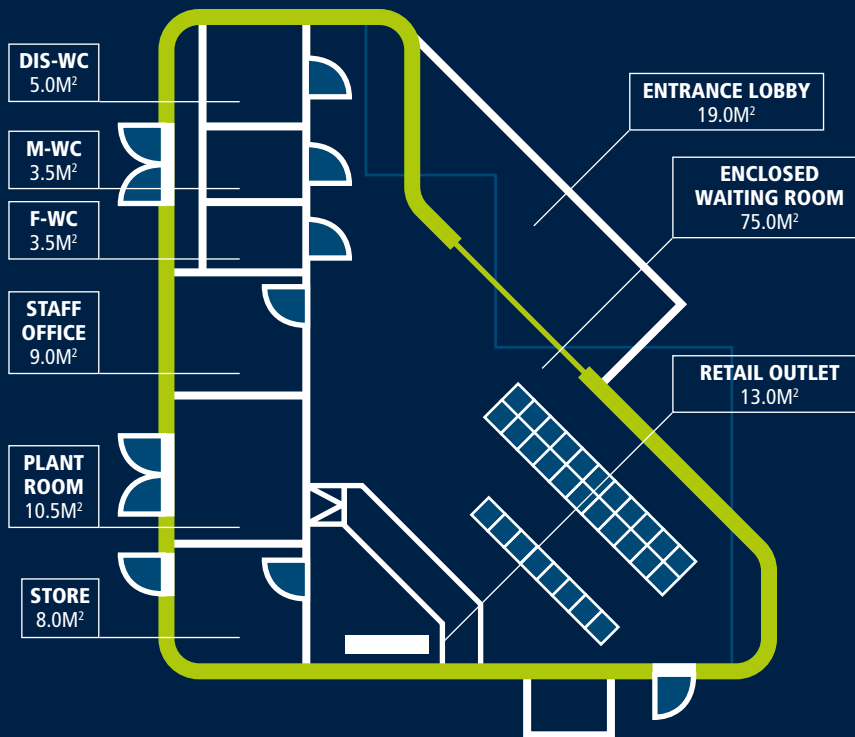

You can get this information in large print, Braille, audio or in another language by calling 023 9283 4288

Portsmouth City Council hereby gives notice that to the extent permitted by law (i) the particulars are set out as a general outline only for the guidance of intending purchasers or lessees and do not constitute part of an offer or contract. (ii) all descriptions, dimensions, references to conditions and necessary permissions for use and occupation, and other details are given in good faith and are believed to be correct, but their accuracy is not guaranteed and any intending purchaser, lessee, mortgagee or other interested person should not rely on them as statements or representations of fact and must satisfy themselves by inspection, enquiries or otherwise as to the correctness of each of them. (iii) no person in the employment of Portsmouth City Council has the authority to make or give any representation of warranty whatever in relation to this property.

Produced by: [marketing@portsmouthcc.gov.uk](mailto:marketing@portsmouthcc.gov.uk) • Published: August 2017 • Ref: 96.103